

ALDER STREET RAMP OPTION

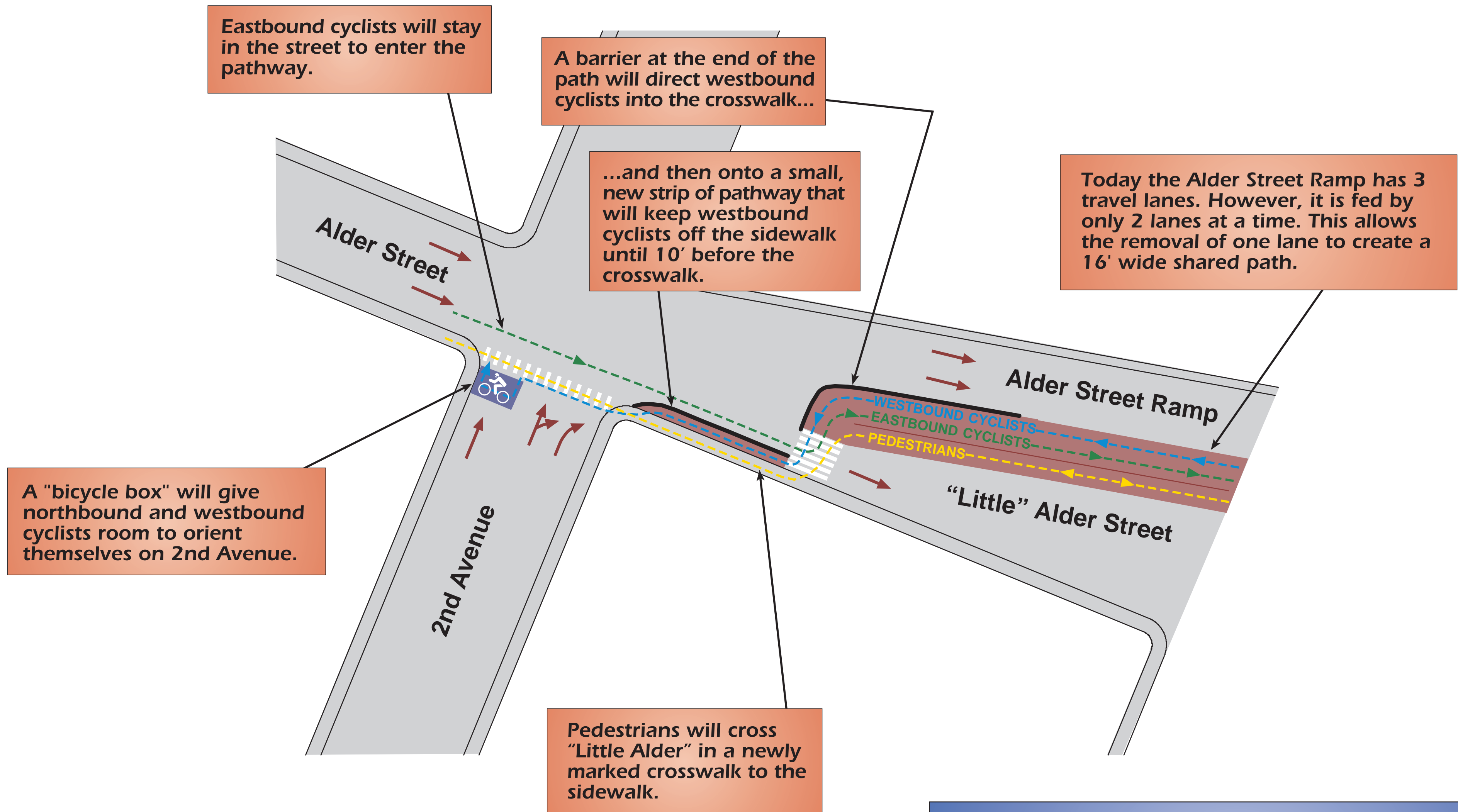

Eastbound cyclists will stay in the street to enter the pathway.

A barrier at the end of the path will direct westbound cyclists into the crosswalk...

...and then onto a small, new strip of pathway that will keep westbound cyclists off the sidewalk until 10' before the crosswalk.

Today the Alder Street Ramp has 3 travel lanes. However, it is fed by only 2 lanes at a time. This allows the removal of one lane to create a 16' wide shared path.

A "bicycle box" will give northbound and westbound cyclists room to orient themselves on 2nd Avenue.

Pedestrians will cross "Little Alder" in a newly marked crosswalk to the sidewalk.

Adding a path to the Alder Street Ramp will create a direct and much-desired pedestrian and bicycle link to Portland's Downtown.

The cost estimate for this ramp is \$293,000.